

P.U.Z.

PUZ - SCHIMBARE DE DESTINATIE FUNCTIONALA DIN ZONA TEA - CULTURI AGRICOLE SI RETELE TEHNICO-EDILITARE IN ZONA ID - INDUSTRIE SI DEPOZITARE

PLAN INCADRARE IN TERITORIU Sc. 1:5000 EXTRAS ETERRA



PLAN SITUATIE Sc. 1:500

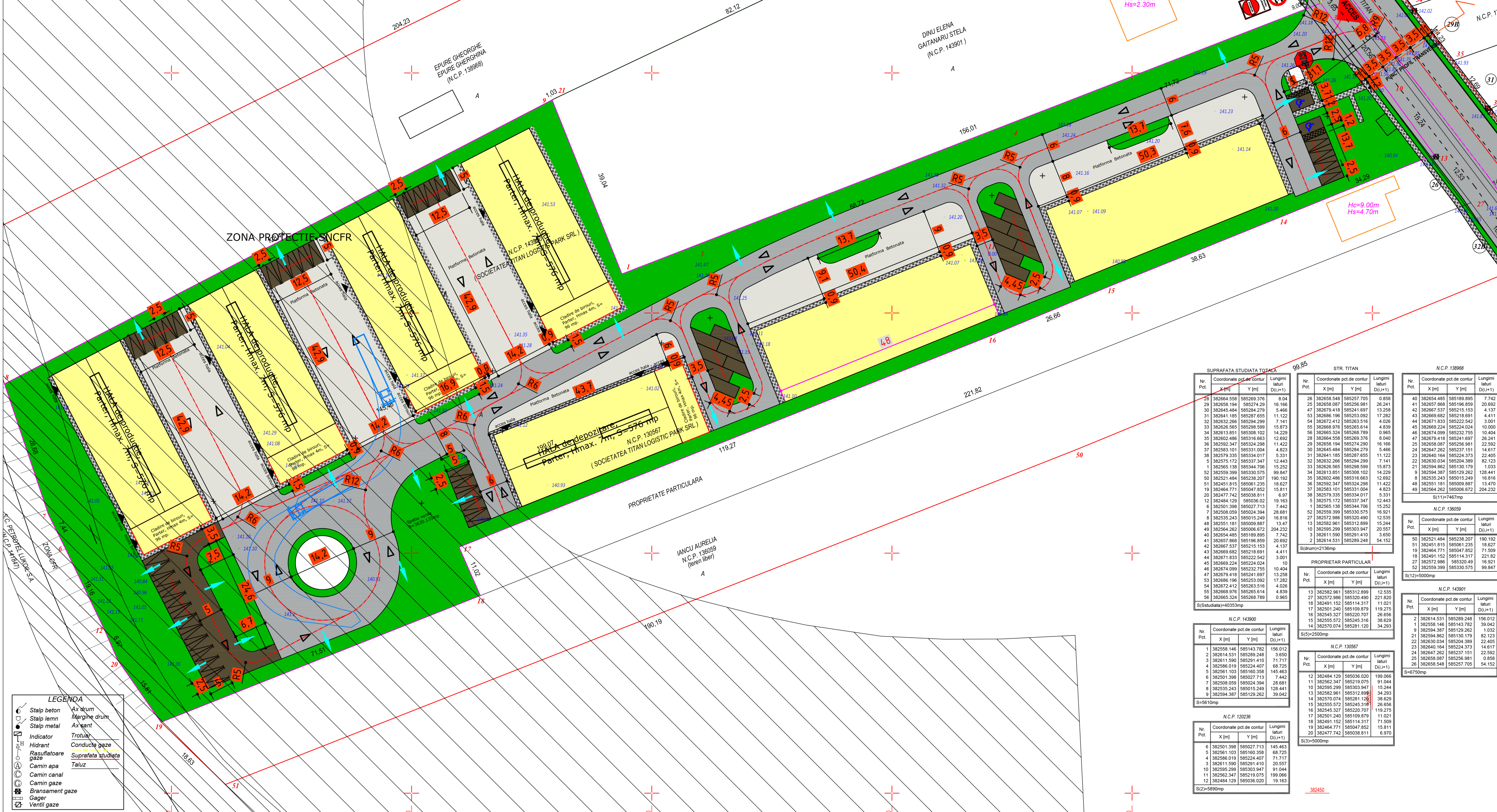

STUDIU ORGANIZAREA CIRCULATIEI SI REGLEMENTARE ACCES

Judetul PRAHOVA

Teritoriu adm.: PLOIESTI - INTRAVILAN

Adresa imobil.: Mun. Ploiesti, Str. Titan, T. 22, A 307/6, A 307/8, A 307/9, A 307/10

Proprietari: SOCIETATEA TITAN LOGISTIC PARK SRL

DINU ELENA; GAITANARU STELA

PROPIETAR PARTICULAR

EPURE GHEORGHE; EPURE GHERGHINA

IANCU AURELIA

MUN. PLOIESTI

Beneficiar: SOCIETATEA TITAN LOGISTIC PARK SRL

NOTA: - SUPRAFATA TOTALA STUDIATA= 40353mp din care

- SUPRAFATA STUDIATA N.C.P. 149185=16500mp

- SUPRAFATA STUDIATA N.C.P. 143901= 6750mp

- SUPRAFATA STUDIATA N.C.P. 138968= 7467mp

- SUPRAFATA STUDIATA N.C.P. 136059= 5000mp

- SUPRAFATA STUDIATA PROPRIETAR PARTICULAR= 2500mp

- SUPRAFATA STUDIATA STR. TITAN= 2136mp

PROFILE TRANSVERSALE Sc. 1:100

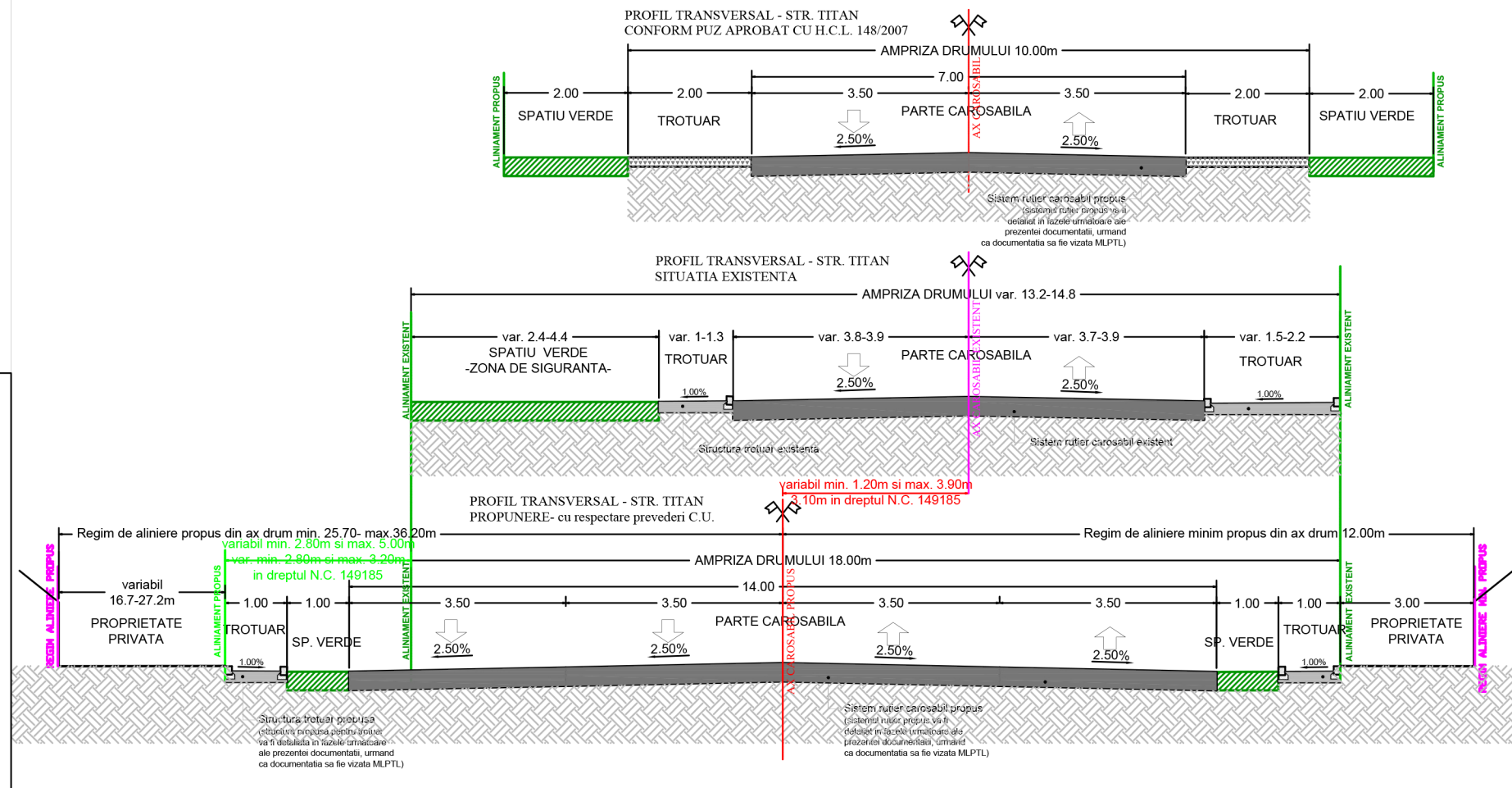

SISTEME RUTIERE Sc. 1:50

DETALIU SISTEM RUTIER A
Se aplica pe caile carosabile drum public, incinta si platforma parcare

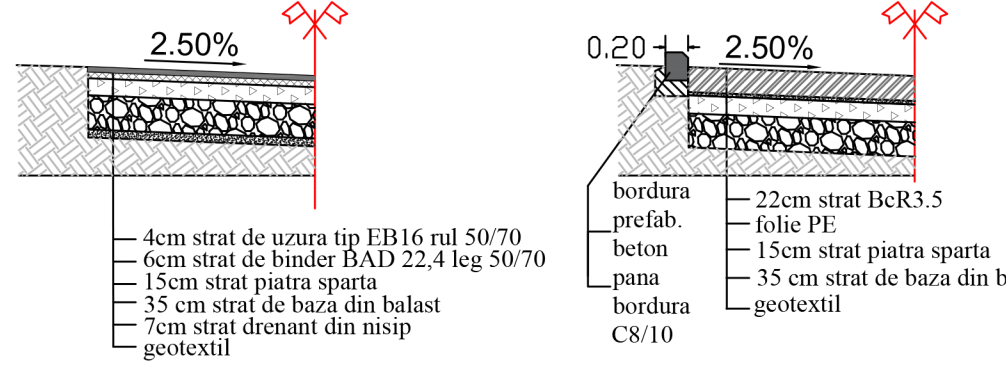

DETALIU SISTEM RUTIER B
Se aplica in incinta - platforma betonata

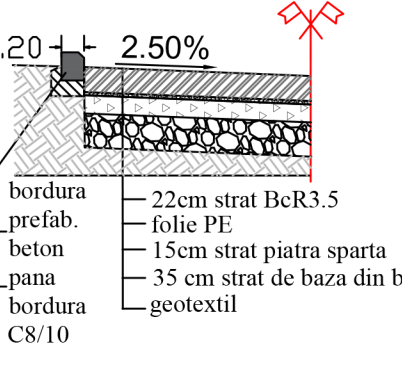

DETALIU SISTEM RUTIER C
Se aplica pe caile pietonale - trotuar drum public

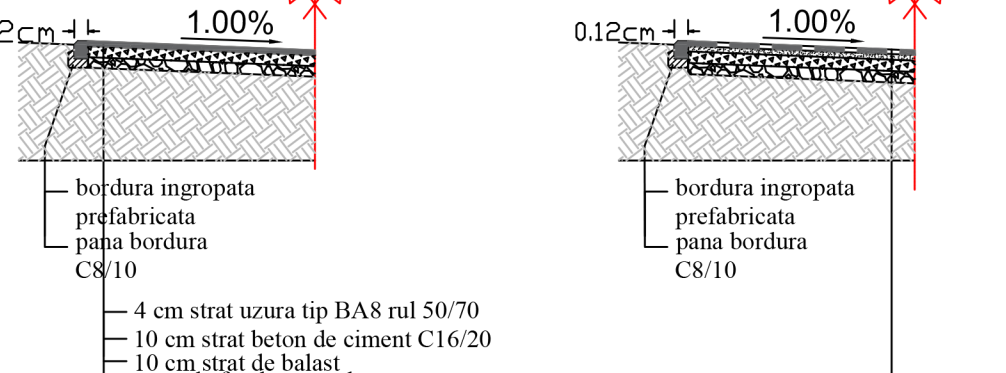

DETALIU SISTEM RUTIER D
Se aplica pe caile pietonale propuse in incinta

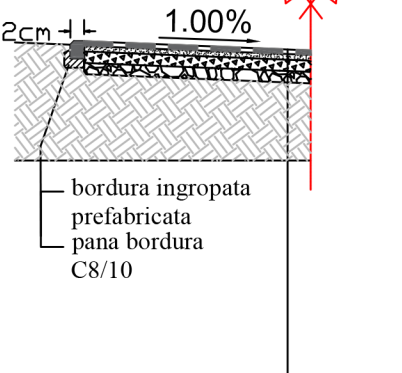

LEGENDA :

Limita teren care a generat studiul: nr. cadastral 149185, S teren = 16 500mp

Limita zona studiata, S = 40 353mp

Constructii existente

Casa poarta propusa

Constructii industriale propuse

Spatiu verde propus incinta

Circulatie carosabila

Circulatie pietonala

Platforme betonate in incinta

Platforma amenajare parcare

Acces teren

Ax existent drum - Str. Titan

Ax propus drum - Str. Titan

Parte carosabila Str. Titan- existent

Parte carosabila Str. Titan-propus (4 fire de circulatie)

Profilare spatiu verde Str. Titan - propunere

Profilare trotuar Str. Titan - propunere

Sens circulatie carosabila

Sens scurgere ape pluviale

PROIECTANT GENERAL: AXELIA TRANS ARH SRL

PROIECTANT DE SPECIALITATE: SMART TOPCAD PRODESIGN SRL

SC TITAN LOGISTIC PARK SRL

PUZ - SCHIMBARE DE DESTINATIE FUNCTIONALA DIN ZONA TEA - CULTURI AGRICOLE SI RETELE TEHNICO-EDILITARE IN ZONA ID - INDUSTRIE SI DEPOZITARE

Amplasament: jud. Prahova, mun. Ploiesti, str. Titan, T. 22, parcela A307/9, 307/8, 307/10, nr. cad. 149185

TITLU PLANSA: INCADRARE IN TERITORIU, PLAN DE SITUATIE, PROFILE TRANSVERSALE, DETALII S.R.

PLANSA C.01